

LPF6768-ZHP Osram PrevaLED Pin Fin LED Cooler ø67mm

Mounting Instruction



With the PrevaLED Core and PrevaLED Core AC, Osram leads the path of versatile LED light modules interchangeable according Zhaga book 3 specifications. With an initial color binning below 3 steps Mc Adam, a wide range of lumen packages from 1.100lm all the way up to 5.000lm and a broad availability of color temperatures, the Osram PrevaLED Core found it's stride in high-end shop and down light applications with an uncompromised lighting quality.

Mounting indicator marks overview

MechaTronix recommends the use of a high thermal conductive interface between the LED module and the LED cooler. Either thermal grease, a thermal pad or a phase change thermal pad thickness 0.1-0.15mm is recommended. Thermal pads or phase change thermal pads can be pre-ap

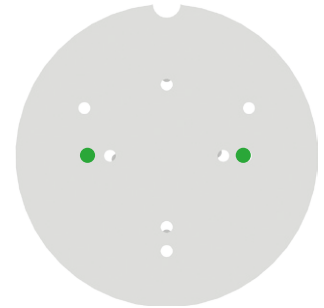

Osram PrevaLED Core Z3

Model names

- PL-CORE-1100-xxx-Z3
- PL-CORE-2000-xxx-Z3
- PL-CORE-3000-xxx-Z3

Mounting

- Direct mounting with 2 screws M3 x 8mm
- Green indicator marks



Osram PrevaLED Core Z4

Model names

- PL-CORE-Z4-2000-xxx
- PL-CORE-Z4-3000-xxx

Mounting

- Direct mounting with 2 screws M3 x 8mm
- Green indicator marks



Osram PrevaLED Core AC

Model names

- PL-CORE-AC-800-xx
- PL-CORE-AC-2000-xx

Mounting

- Direct mounting with 2 screws M3 x 8mm
- Green indicator marks



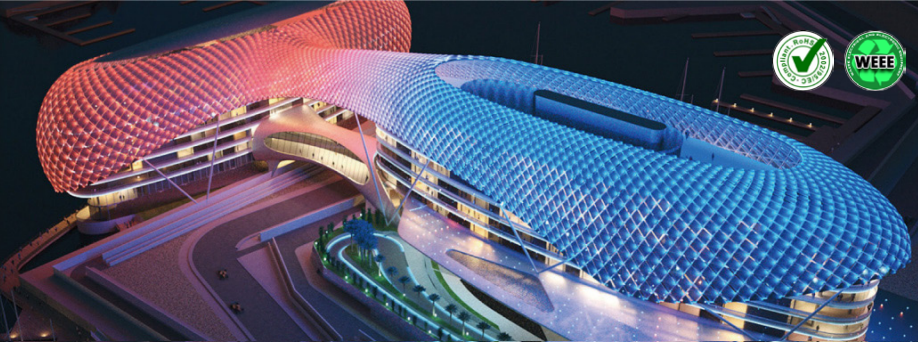

LPF6768-ZHP

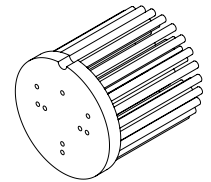

ø67 - H68 (mm)
Rth 2.1 °C/W - Power Pd 24W

[MORE PRODUCT DETAILS](#)

LPF6768-ZHP Osram PrevaLED Pin Fin LED Cooler ø67mm

Mounting Instruction

Osram PrevaLED Core AC PRO

Model names

- PL-CORE-AC-PRO-2000-xxx
- PL-CORE-AC-PRO-3000-xxx

Mounting

- Direct mounting with 2 screws M3 x 8mm
Green indicator marks

